



Laser class 2 in acc. with IEC 60825-1

www.disto.com



SAP. No. 792 325a

Operation



Overview

- 1 Status Bar/Level
- 2 Reference
- 3 Active Function
- 4 Main Line (Result)
- 5 Selection keys linked to the symbol above
- 6 ON/DIST
- 7 Pointfinder (viewscreen)
- 8 Function Screen
- 9 Navigation
- 10 Clear/Off
- 11 Add/Subtract

Unlock keypad



Quick Start Leica DISTO™ E7500i



- when it has to be right

Leica
Geosystems

(Navigate) Functions



? Helpfunctions

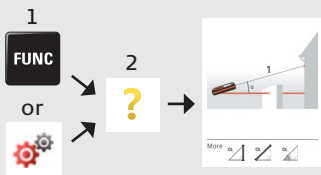

Reference/tripod



Settings

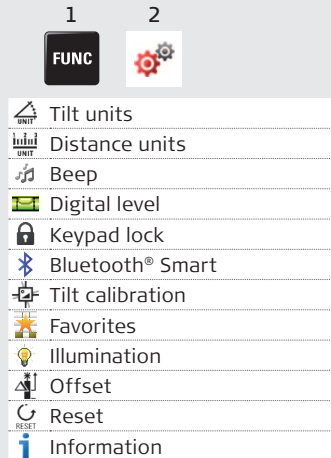

More results



Memory

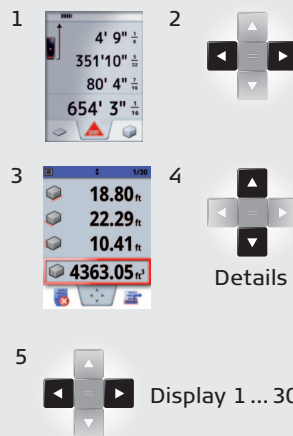

Pointfinder

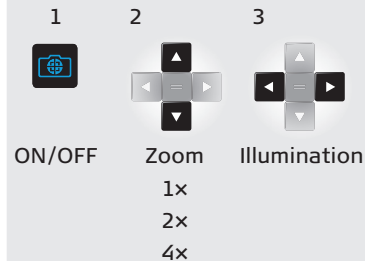

Personalized favorites

